

WITNESHAM

Proposed Settlement Classification: Key Service Centre

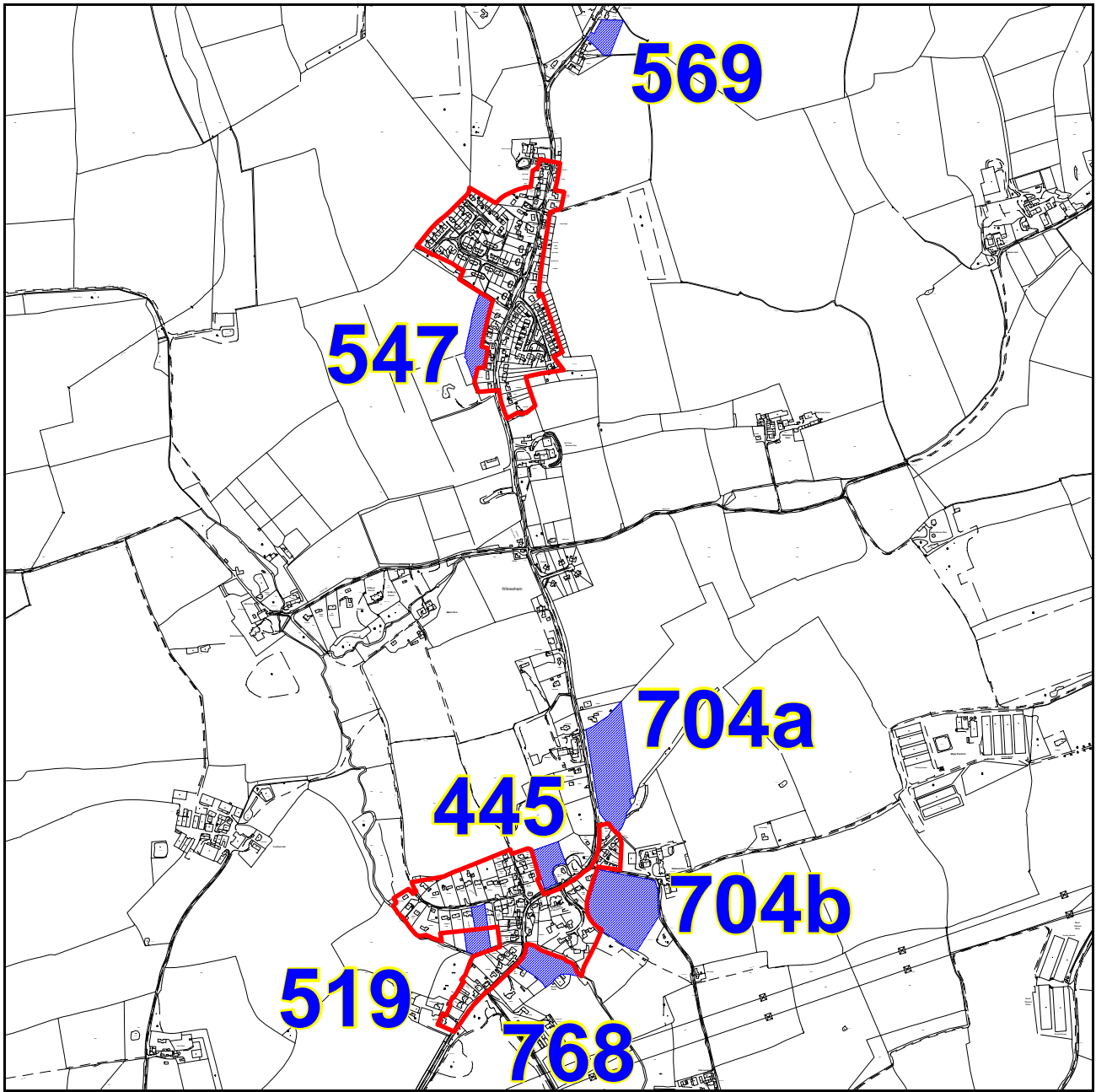

© Crown copyright. All rights reserved 100019684, 2008)

Scale: 1:15000



There are 7 site proposals in the parish.

Reference	Location and Grid References
445	Land adj to Warrens Barn, The Street, Witnesham (618403, 250277)
519	Land at and surrounding Greenway, Hall Lane, Witnesham (618239, 250113)
547	Land to the rear of Leaside Lodge, B1077, Witnesham (618238, 251517)
569	Land to the South of Primary School, Witnesham (618538, 252223)
678	Land at Street Farm, Ipswich Road, Witnesham (618397, 250035)
704a	Land north-west of Redhouse Farm and South of Springfield, Witnesham (618551, 250499)
704b	Land adj to Tanglewood, The Street, Witnesham (618581, 250172)

445 - Land adjacent to Warrens Barn, The Street, Winesham

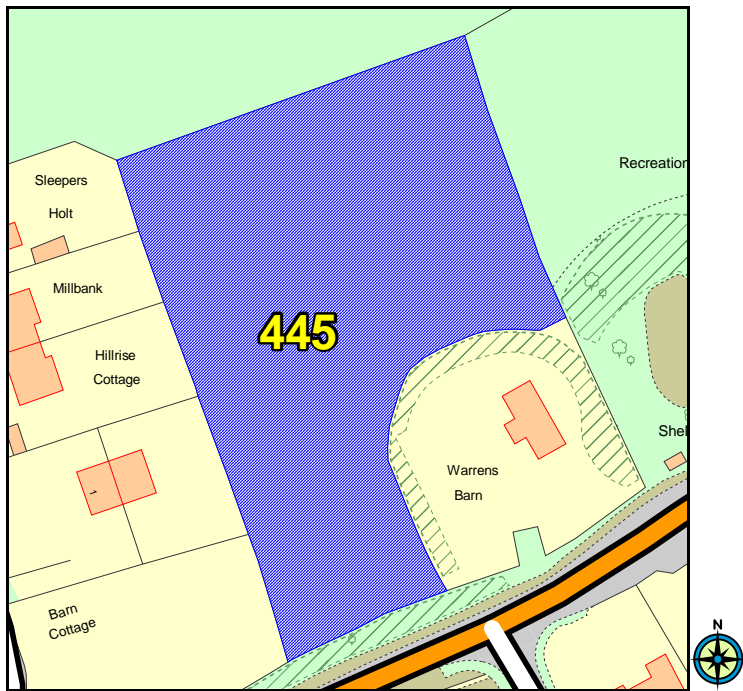

© Crown copyright. All rights reserved 100019684, 2008

Land Use Type	Brownfield
Natural Environment Issues	Protected Species (59m), adjacent Special Landscape Area
Built Environment Issues	NO
Flood Zone (1,2,3)	1
Recreation Issues	NO
Other Issues	NO

Area (Ha)	Proposal Type	Description
0.47	physical limits extension	site proposed for housing

519 - Land at and surrounding Greenway, Hall Lane, Winesham

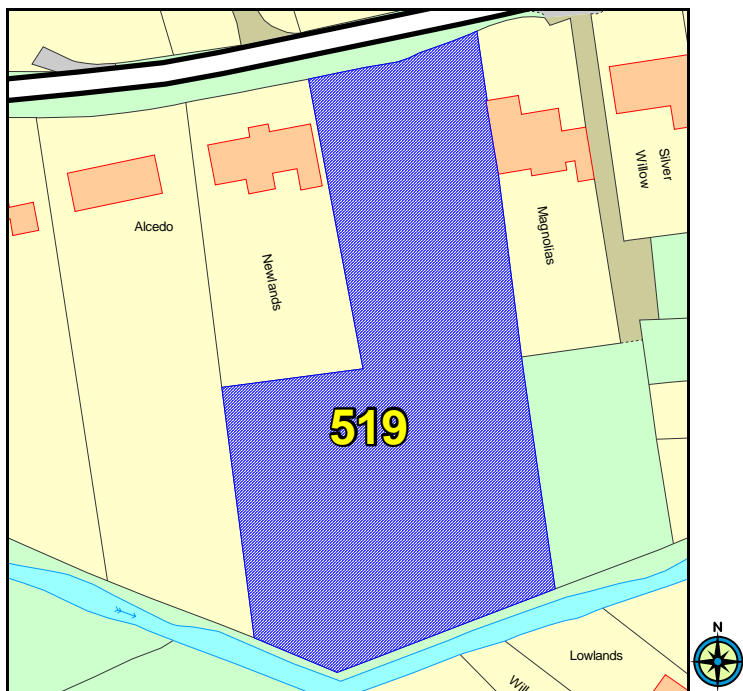

© Crown copyright. All rights reserved 100019684, 2008

Land Use Type	Brownfield
Natural Environment Issues	Protected Species (15m), Special Landscape Area
Built Environment Issues	NO
Flood Zone (1,2,3)	3 (40%)
Recreation Issues	NO
Other Issues	NO

Area (Ha)	Proposal Type	Description
0.46	physical limits extension	n/a

547 - Land to the rear of Leaside Lodge, B1077, Witnesham

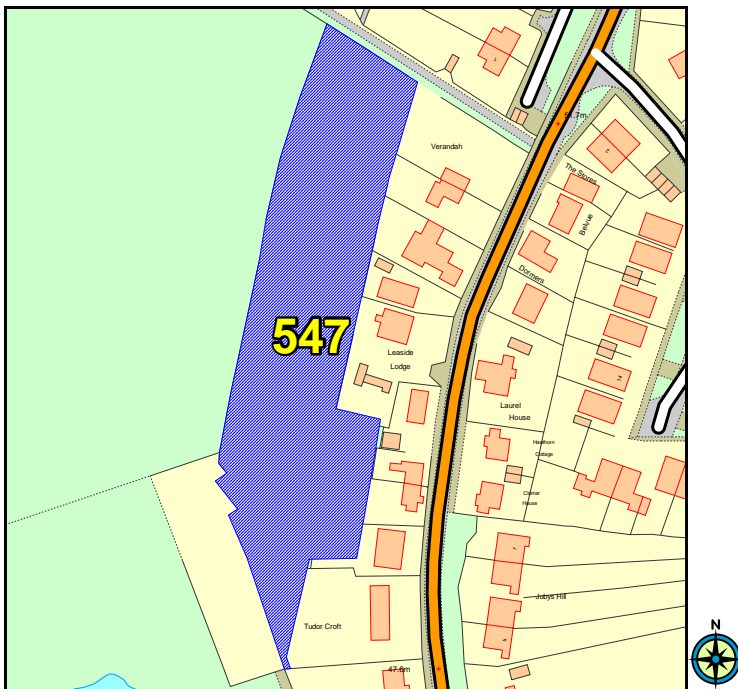

© Crown copyright. All rights reserved 100019684, 2008

Land Use Type	Brownfield
Natural Environment Issues	Protected Species (434m)
Built Environment Issues	NO
Flood Zone (1,2,3)	1
Recreation Issues	NO
Other Issues	

Area (Ha)	Proposal Type	Description
0.7	physical limits extension	n/a

569 - Land to the South of Primary School, Witnesham



© Crown copyright. All rights reserved 100019684, 2008

Land Use Type	Greenfield
Natural Environment Issues	NO
Built Environment Issues	NO
Flood Zone (1,2,3)	1
Recreation Issues	NO
Other Issues	NO

Area (Ha)	Proposal Type	Description
0.41	housing	site proposed for mixed housing

678 - Land at Street Farm, Ipswich Road, Witnesham

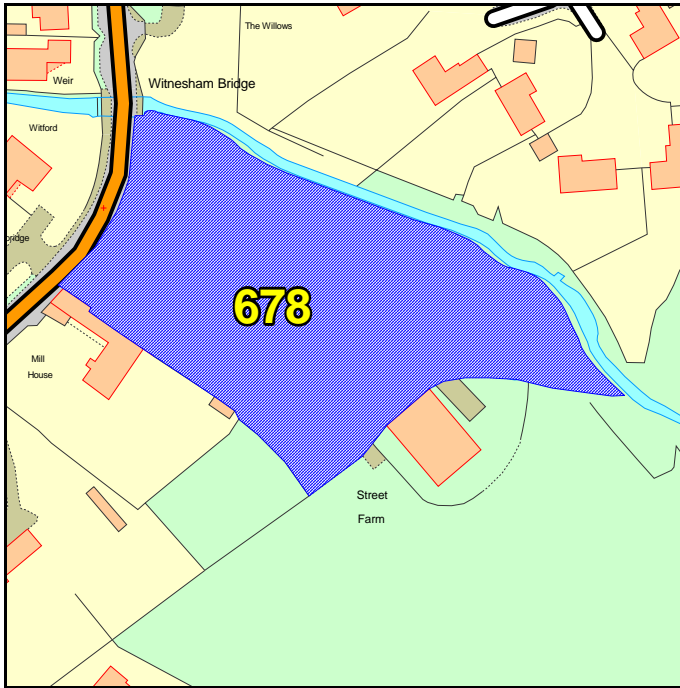

© Crown copyright. All rights reserved 100019684, 2008

Land Use Type
Greenfield
Natural Environment Issues
Protected Species (36m), Special Landscape Area
Built Environment Issues
listed building
Flood Zone (1,2,3)
3 (20%)
Recreation Issues
NO
Other Issues
NO

Area (Ha)	Proposal Type	Description
0.71	physical limits extension	n/a

704a- Land North-West of Redhouse Farm and South of Springfield, Witnesham

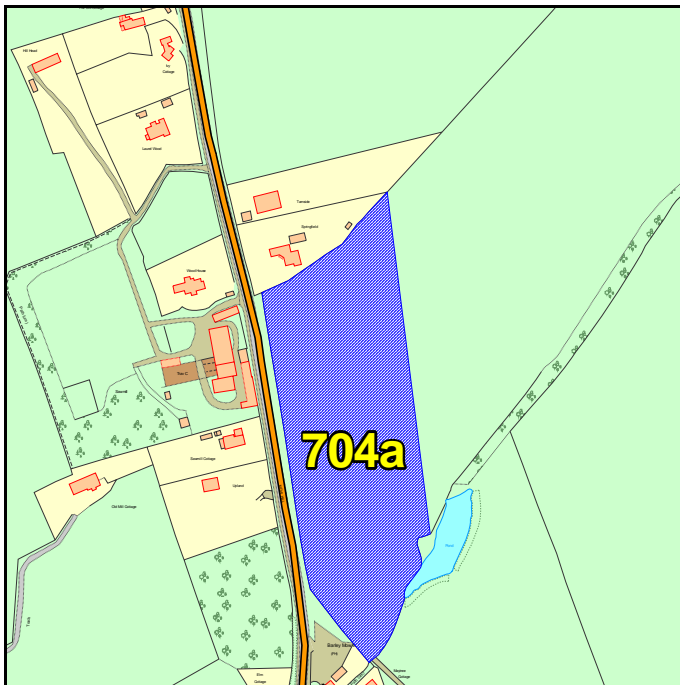

© Crown copyright. All rights reserved 100019684, 2008

Land Use Type
Greenfield
Natural Environment Issues
Protected Species (142m)
Built Environment Issues
NO
Flood Zone (1,2,3)
1
Recreation Issues
NO
Other Issues

Area (Ha)	Proposal Type	Description
2.12	housing	proposed that site be considered for future development

704b - Land adjacent to Tanglewood, The Street, Witnesham

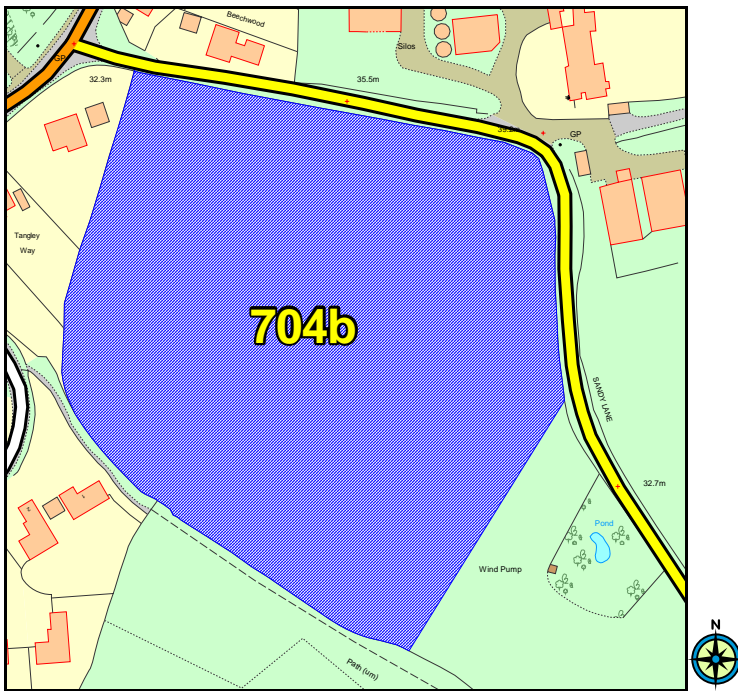

© Crown copyright. All rights reserved 100019684, 2008

Land Use Type
Greenfield
Natural Environment Issues
Protected Species, Special Landscape Area
Built Environment Issues
NO
Flood Zone (1,2,3)
1
Recreation Issues
NO
Other Issues
NO

Area (Ha)	Proposal Type	Description
2.27	housing	proposed that site be considered for future development