

KELSALE-CUM-CARLTON

Proposed Settlement Classification: Local Service Centre

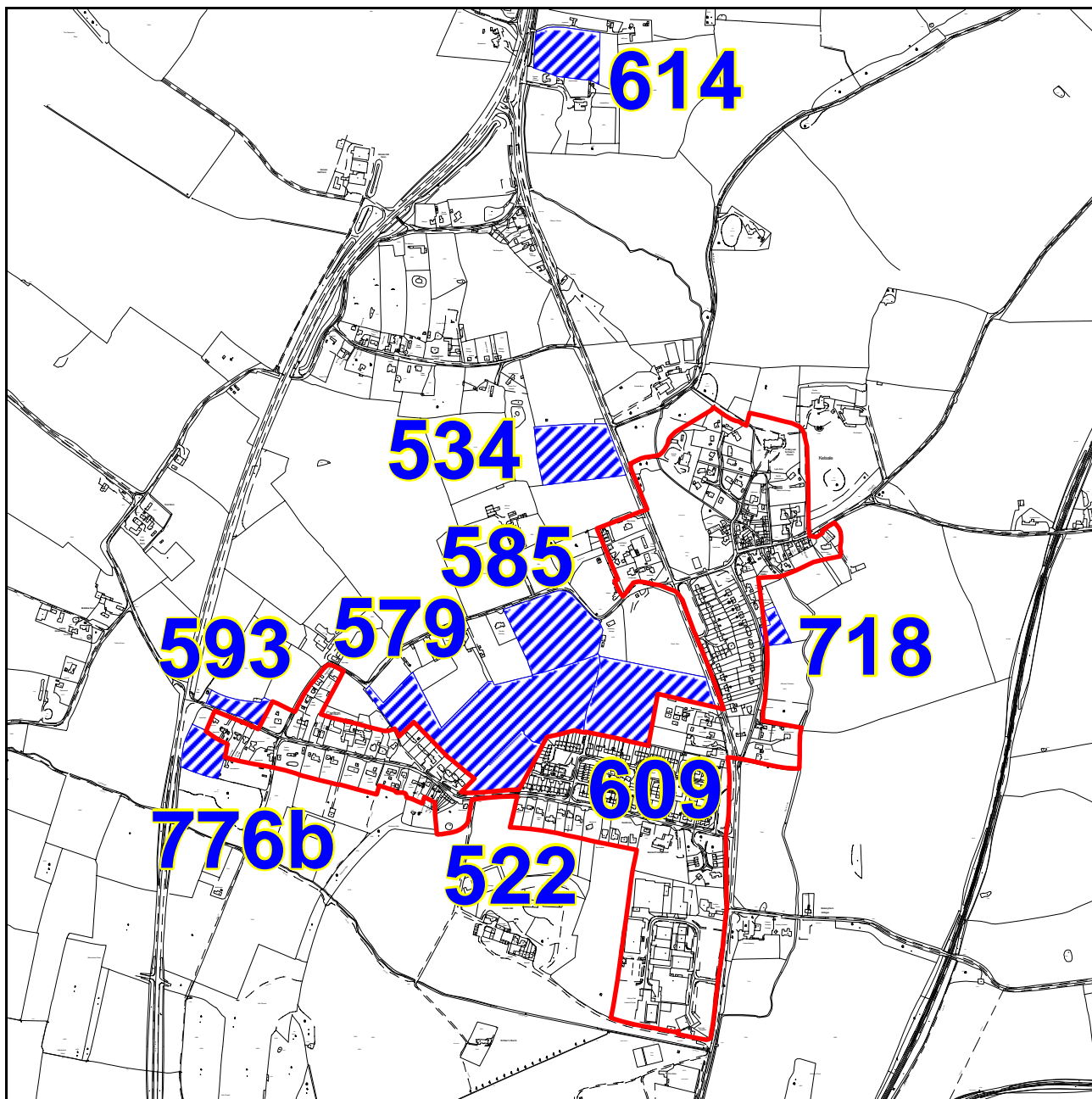

© Crown copyright. All rights reserved 100019684, 2008)

Scale: 1:12500



There are 9 site proposals in the parish.

Reference	Location and Grid References
522	Land adj to Orchard House, Carlton Road, Kelsale-cum-Carlton (638266, 264598)
534	Land north of White Gables, Main Road, Kelsale-cum-Carlton (638408, 265157)
579	Land adjacent to 8 Carlton Road, Kelsale-cum-Carlton (638080, 264660)
585	Land at and surrounding Fir Trees, Rosemary Lane, Kelsale-cum-Carlton (638366, 264810)
609	Land adj to Alderlee, Main Road, Kelsale-cum-Carlton (638525, 264679)
614	Land adj to Lynwood, Main Road, Kelsale-cum-Carlton (638392, 265938)

718	Land adj to Sandpit Cottage, Low Road, Kelsale-cum-Carlton (638793, 264813)
593	Land adj to The Oaks, Carlton Road, Kelsale-cum-Carlton (637756, 264662)
776b	Land to the rear of Home Port, Carlton Road, Kelsale-cum-Carlton (637682, 264573)

609 - Land adjacent to Alderlee, Main Road, Kelsale

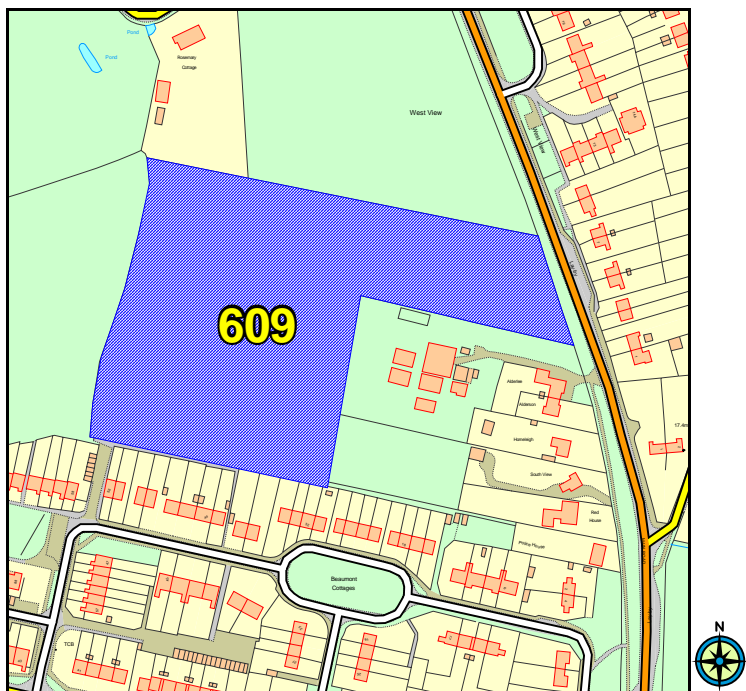

© Crown copyright. All rights reserved 100019684, 2008

Land Use Type	Greenfield
Natural Environment Issues	Protected Species (120m)
Built Environment Issues	NO
Flood Zone (1,2,3)	1
Recreation Issues	NO
Other Issues	NO

Area (Ha)	Proposal Type	Description
2.42	physical limits extension	proposed for single dwelling

522 - Land adjacent to Pear Tree Close, Kelsale-cum-Carlton

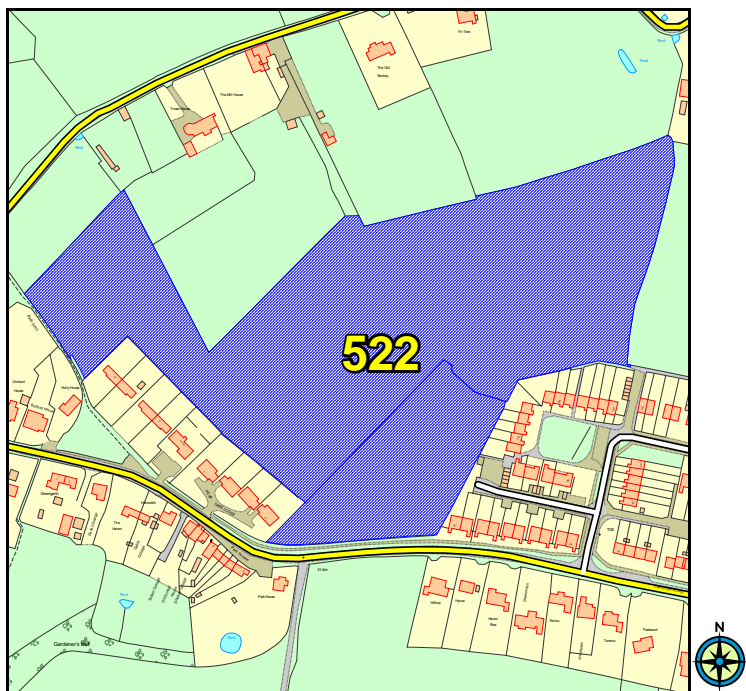

© Crown copyright. All rights reserved 100019684, 2008

Land Use Type	Greenfield
Natural Environment Issues	Protected Species (84m)
Built Environment Issues	NO
Flood Zone (1,2,3)	1
Recreation Issues	NO
Other Issues	minerals consultation

Area (Ha)	Proposal Type	Description
5.48	physical limits extension	n/a

534 - Land north of White Gables, Main Road, Kelsale-cum-Carlton

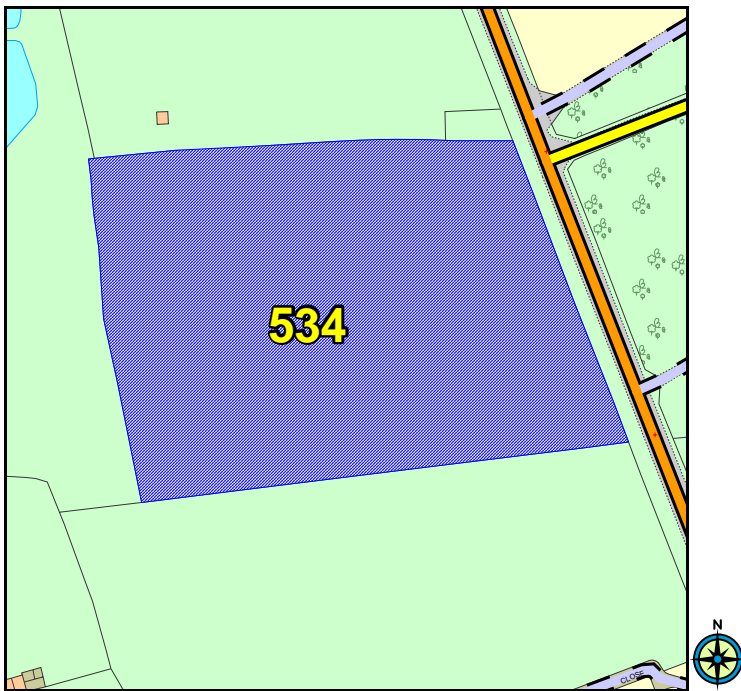

© Crown copyright. All rights reserved 100019684, 2008

Land Use Type	Greenfield
Natural Environment Issues	Protected Species (203m)
Built Environment Issues	NO
Flood Zone (1,2,3)	1
Recreation Issues	NO
Other Issues	minerals consultation

Area (Ha)	Proposal Type	Description
1.68	physical limits extension	site proposed for affordable housing

579 - Land adjacent to 8 Carlton Road, Kelsale-cum-Carlton

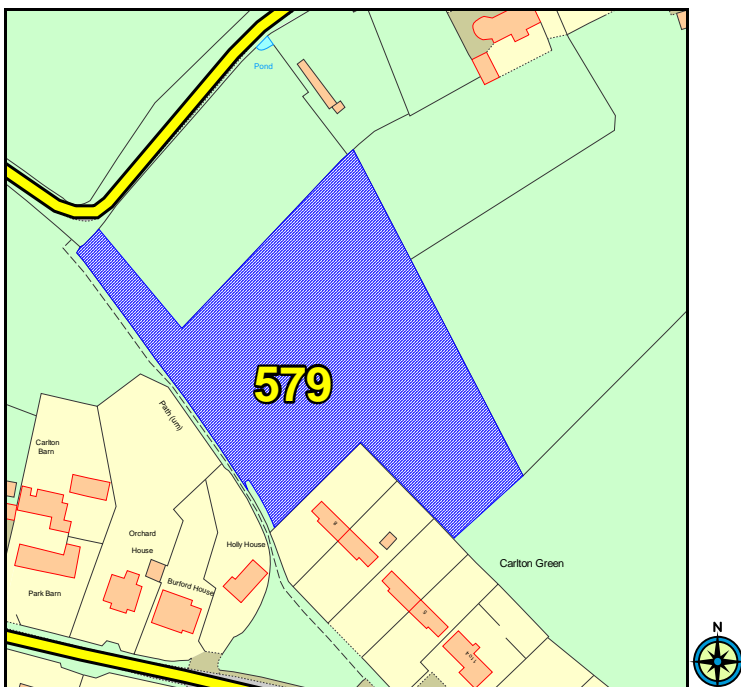

© Crown copyright. All rights reserved 100019684, 2008

Land Use Type	Greenfield
Natural Environment Issues	Protected Species (251m)
Built Environment Issues	NO
Flood Zone (1,2,3)	1
Recreation Issues	NO
Other Issues	NO

Area (Ha)	Proposal Type	Description
0.84	physical limits extension	n/a

585 - Land at and surrounding Fir Trees, Rosemary Lane, Kelsale-cum-Carlton

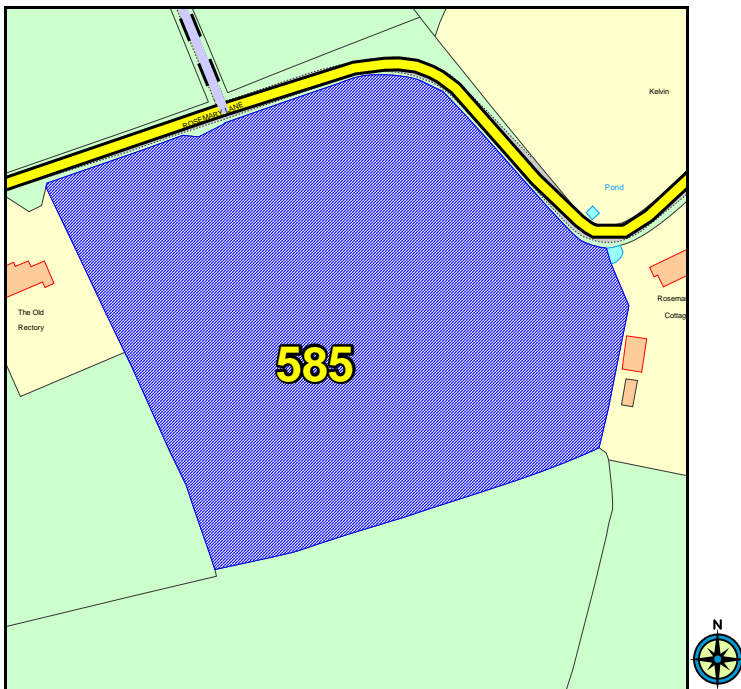

© Crown copyright. All rights reserved 100019684, 2008

Land Use Type	Mixed
Natural Environment Issues	Protected Species (293m)
Built Environment Issues	NO
Flood Zone (1,2,3)	1
Recreation Issues	NO
Other Issues	NO

Area (Ha)	Proposal Type	Description
2.06	physical limits extension	n/a

614 - Land adjacent to Lynwood, Main Road, Kelsale-cum-Carlton



© Crown copyright. All rights reserved 100019684, 2008

Land Use Type	Greenfield
Natural Environment Issues	Protected Species (74m)
Built Environment Issues	NO
Flood Zone (1,2,3)	1
Recreation Issues	NO
Other Issues	minerals consultation

Area (Ha)	Proposal Type	Description
1.17	n/a	site proposed for future development

718 - Land adjacent to Sandpit Cottage, Low Road, Kelsale-cum-Carlton

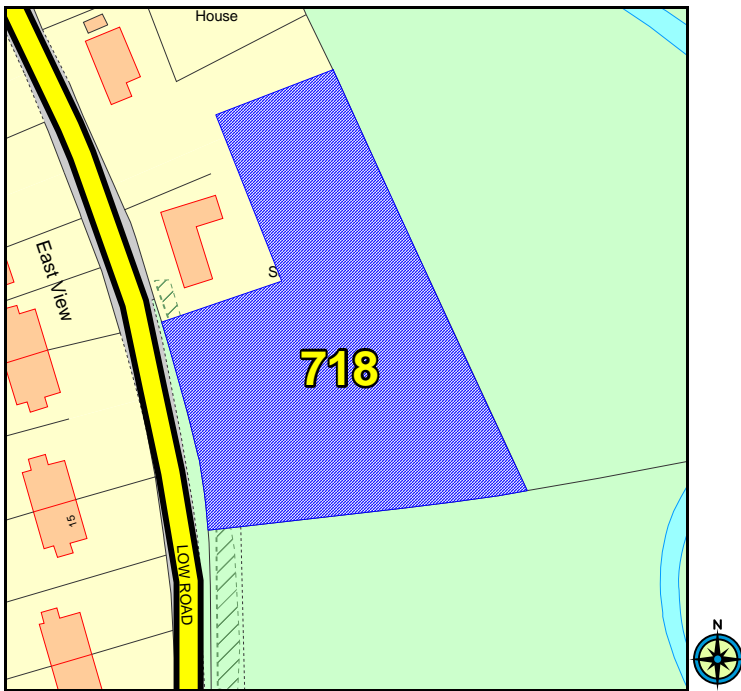

© Crown copyright. All rights reserved 100019684, 2008

Land Use Type
Unknown
Natural Environment Issues
Protected Species (66m)
Built Environment Issues
NO
Flood Zone (1,2,3)
1
Recreation Issues
NO
Other Issues
NO

Area (Ha)	Proposal Type	Description
0.26	physical limits extension	site proposed for extension to include residential development